



# FFHB

**Integrated Flat Face Cartridge with special button sleeve for single line functionality.**

Integrated flat face cartridge, suitable for hydraulic multiconnections and manifolds. Thanks to its special sleeve button it is possible to connect the cartridge with dedicated plate counterpart or with single couplers. The cartridge allows frontal assembly with a dedicated tool. Conforms to ISO 16028 interchange standard.



## Applications



## Pressure Drop

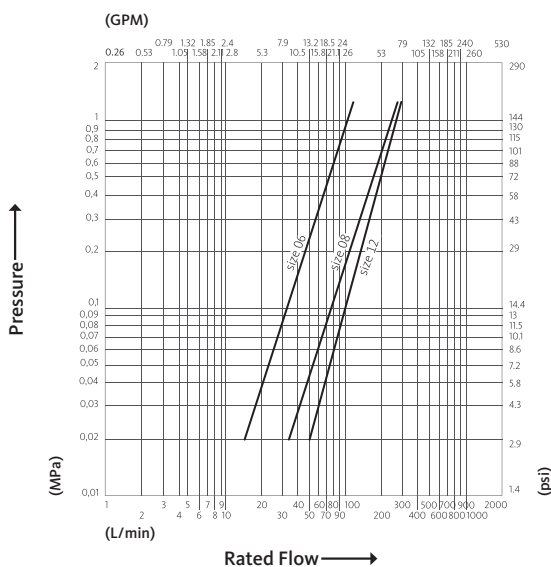

Test performed according to ISO 18869

## Technical Specifications

dash	Size mm	inch	Working Pressure (MPa)	Flow Rate (l/min)	Spillage (ml)	Force to Connect (N)	Burst pressure (MPa)		
							Male	Female	Male + Female
06	10	3/8"	35	45	0.008		140	180	
08	12.5	1/2"	35	110	0.01		140	160	
12	20	3/4"	35	150	0.02		140	140	

Material	<b>Steel; Plastic</b>
Seals	<b>PUR</b>
Working temperatures	<b>- 25 °C to + 100 °C</b>
Surface treatment	<b>MATE 1000 (ZnNi)</b>
Series Interchange	<b>ISO 16028</b>

Valve Type	<b>Flat</b>
Connection	<b>Push to Connect</b>
Disconnection	<b>Sleeve Retraction</b>
Connection Under Pressure	<b>Not Allowed</b>



# FFHB

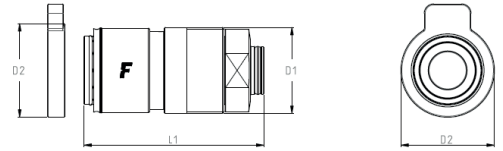

Size		Thread details			FEMALE						
mm	inch	Thread Type	Standard	Thread	Part Number	L (L1 + Thread)		D1		HEX1	
						mm	inch	mm	inch	mm	inch
10	3/8"				FFHB 06 F N	69.4	2.73	30	1.18		
12.5	1/2"				FFHB 08 F G	74.6	2.93	38	1.5		
12.5	1/2"				FFHB 08 F N	74.6	2.93	38	1.5		
20	3/4"				FFHB 12 F G	96.3	3.79	46	1.8		
20	3/4"				FFHB 12 F N	96.3	3.79	46	1.8		