

VVM



Screw to connect standard couplings, metal-to-metal sealing.

VVM couplings are characterized by screw to connect sleeve and metal-to-metal sealing system when disconnected. Poppet valve shut-off.



Applications



Pressure Drop

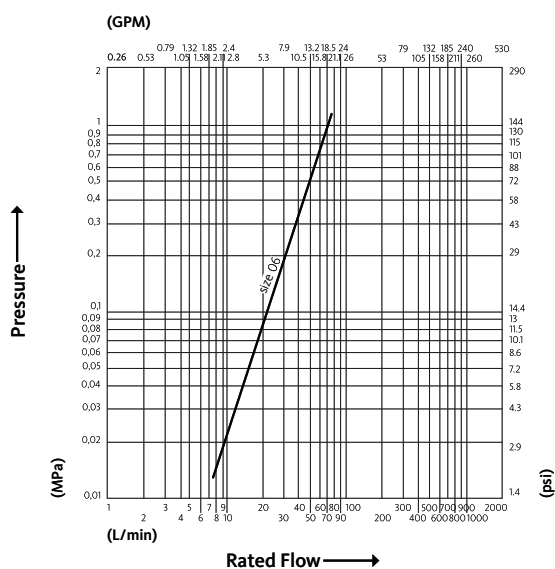

Test performed according to ISO 18869

Technical Specifications

dash	Size mm	inch	Working Pressure (MPa)	Flow Rate (l/min)	Spillage (ml)	Force to Connect (N)	Burst pressure (MPa)		
							Male	Female	Male + Female
06	10	3/8"	43	45	2	130	140	210	

Material	Steel
Seals	NBR
Working temperatures	- 25 °C to + 125 °C
Surface treatment	MATE 500 (CrIII)
Series Interchange	FASTER

Valve Type	Poppet
Connection	Screw to Connect
Disconnection	Unscrew to Disconnect
Connection Under Pressure	Allowed Residual



VVM

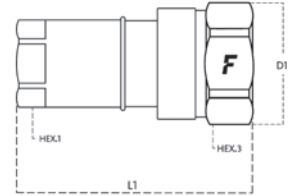

Size		Thread details			FEMALE						
mm	inch	Thread Type	Standard	Thread	Part Number	L (L1 + Thread)		D1		HEX1	
						mm	inch	mm	inch	mm	inch
10	3/8"	F BSPP	ISO 1179-1	BSPP 3/8" FEMALE	VVM 38 GAS F	74	2.91	38	1.5	24	0.94

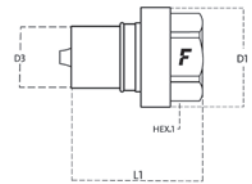

Size		Thread details			MALE								
mm	inch	Thread Type	Standard	Thread	Part Number	L (L1 + Thread)		D1		D3		HEX1	
						mm	inch	mm	inch	mm	inch	mm	inch
10	3/8"	F BSPP	ISO 1179-1	BSPP 3/8" FEMALE	VVM 38 GAS M	40.5	1.59	30.4	1.2	19	0.75	24	0.94

VVM Accessories and Spares

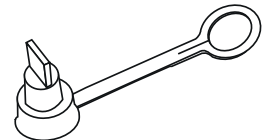
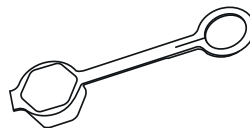

PVC dust protections

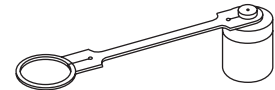
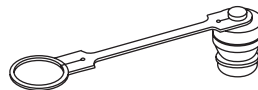

Aluminium dust protections

