



OGVFR

Screw to Connect couplings, Lloyd's certified, suitable for Oil & Gas applications.

Robust sleeve design, poppet valve and ACME connection thread. Thanks to special components and seals, OGVFR couplings are API 16 D certified and suitable for BOP applications.



Applications



Pressure Drop

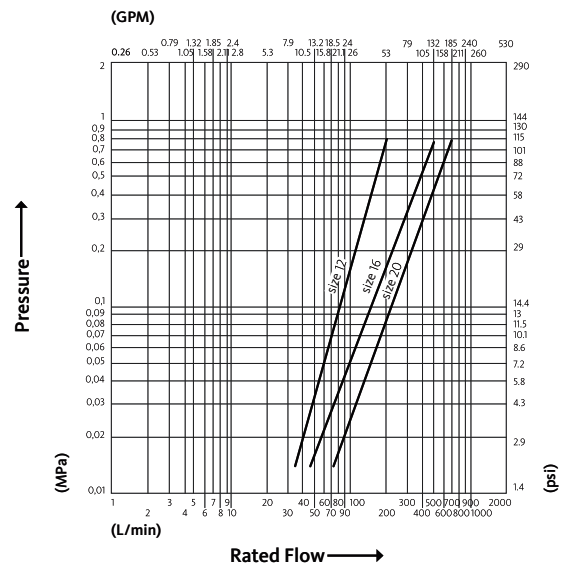

Technical Specifications

dash	Size mm	inch	Working Pressure (MPa)	Flow Rate (l/min)	Spillage (ml)	Force to Connect (N)	Burst pressure (MPa)		
							Male	Female	Male + Female
12	20	3/4"	34.5	120	8	0	168	160	165
16	25	1"	34.5	230	18	0	165	165	172
20	31.5	1-1/4"	34.5	320	21	0	180	200	178

Material	Steel
Seals	SPECIAL
Working temperatures	BOP
Surface treatment	MATE 500 (CrII); Paint
Series Interchange	MARKET

Valve Type	Poppet
Connection	Screw to Connect
Disconnection	Unscrew to Disconnect
Connection Under Pressure	Allowed Residual



OGVFR

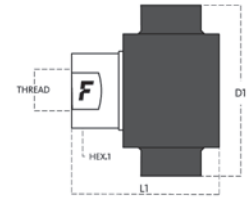

Size		Thread details			FEMALE						
mm	inch	Thread Type	Standard	Thread	Part Number	L (L1 + Thread)		D1		HEX1	
						mm	inch	mm	inch	mm	inch
20	3/4"	F NPSF	ANSI B1.20.3	NPSF 3/4 FEMALE	OGVFR12 34NPS F	72.2	2.84	65	2.56	32	1.26
25	1"	F NPSF	ANSI B1.20.3	NPSF 1 FEMALE	OGVFR16 1NPS F	87.6	3.45	105.5	4.15	41	1.61
31.5	1-1/4"	F NPTF	ANSI B1.20.3	NPTF 1-1/4" FEMALE	OGVFR20 114NPTF	111.9	4.41	118.2	4.65	50	1.97

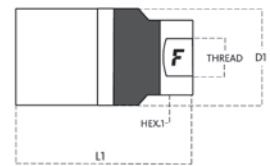

Size		Thread details			MALE								
mm	inch	Thread Type	Standard	Thread	Part Number	L (L1 + Thread)		D1		D3		HEX1	
						mm	inch	mm	inch	mm	inch	mm	inch
20	3/4"	F NPSF	ANSI B1.20.3	NPSF 3/4 FEMALE	OGVFR12 34NPS M	83.1	3.27	44.4	1.74			32	1.26
25	1"	F NPSF	ANSI B1.20.3	NPSF 1 FEMALE	OGVFR16 1NPS M	106	4.17	57.1	2.25			41	1.61
31.5	1-1/4"	F NPTF	ANSI B1.20.3	NPTF 1-1/4" FEMALE	OGVFR20 114NPTM	136.5	5.37	66.4	2.62			50	1.97

OGVFR Accessories and Spares



Aluminium dust protections

