

# FFC



## Flat face cartridge couplings, stainless steel.

Self-aligning flat face couplings for multiconnections. Misalignments up to  $\pm 0.5$  mm and  $\pm 1^\circ$  (angular) are automatically compensated during the connection. Stainless steel components (AISI 316) with Viton seals. Faster proprietary profile. Cartridges without thread, to be installed into machined housing.



## Applications



## Pressure Drop

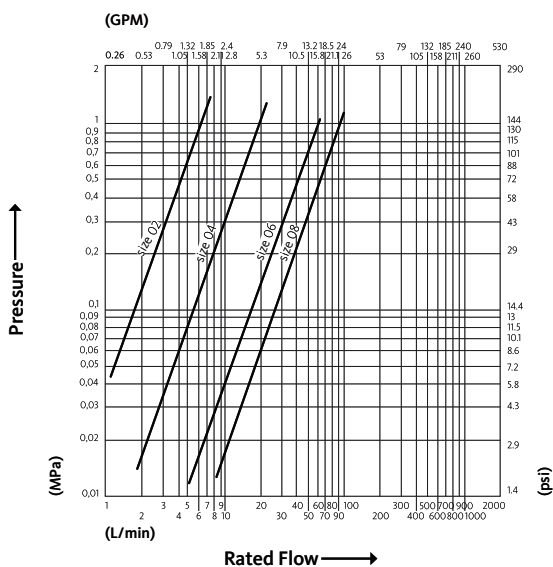

Test performed according to ISO 18869

## Technical Specifications

dash	Size mm	inch	Working Pressure (MPa)	Flow Rate (l/min)	Spillage (ml)	Force to Connect (N)	Burst pressure (MPa)		
							Male	Female	Male + Female
02	3.2	1/8"	25	2.5	0.002	80	100	100	130
04	6.3	1/4"	32	8	0.002	80	150	90	130
06	10	3/8"	25	23	0.006	110	90	100	100
08	12.5	1/2"	45	35	0.006	185	140	80	180

Material **Stainless Steel**

Seals **VITON**

Working temperatures **- 20 °C to +200 °C**

Surface treatment

Series Interchange **MARKET**

Valve Type **Flat**

Connection **Special**

Disconnection **Special**

Connection Under Pressure **Not Allowed**



**FFC**

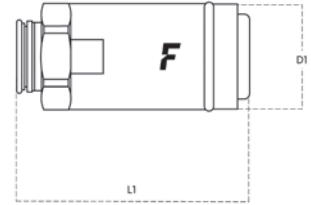

Size		Thread details			FEMALE						
mm	inch	Thread Type	Standard	Thread	Part Number	L (L1 + Thread)		D1		HEX1	
						mm	inch	mm	inch	mm	inch
6.3	1/4"				FFC14 F 2V	44.8	1.76	19	0.75		
10	3/8"				FFC38 F 2V	49.3	1.94	23.9	0.94		
12.5	1/2"				FFC12 F 2V	70.8	2.79	31.3	1.23		

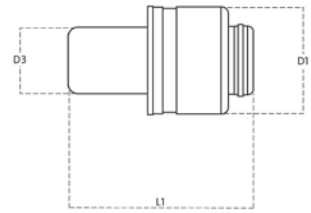

Size		Thread details			MALE								
mm	inch	Thread Type	Standard	Thread	Part Number	L (L1 + Thread)		D1		D3		HEX1	
						mm	inch	mm	inch	mm	inch	mm	inch
6.3	1/4"				FFC14 M 2V	36	1.42	19.6	0.77	12.1	0.48		
10	3/8"				FFC38 M 2V	40.5	1.59	24.5	0.96	16.1	0.63		
12.5	1/2"				FFC12 M 2V	56	2.2	32.5	1.28	19.7	0.78		