

PRESA DI FORZA A COMANDO PNEUMATICO PNEUMATIC CLUTCH POWER TAKE-OFF

CODICE PTO
PTO CODE

050-046-00171

CAMBIO
GEARBOX

FULLER



Attacco aria
Air inlet
G 1/8

Interruttore segnalazione PTO inserita / PTO pressure signal switch

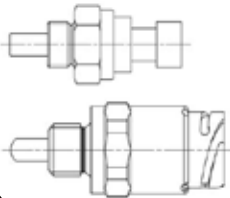

PACKARD
311-001-00116

DIN 72585
311-001-00205

OPTIONAL
Da ordinare separatamente
To be ordered separately

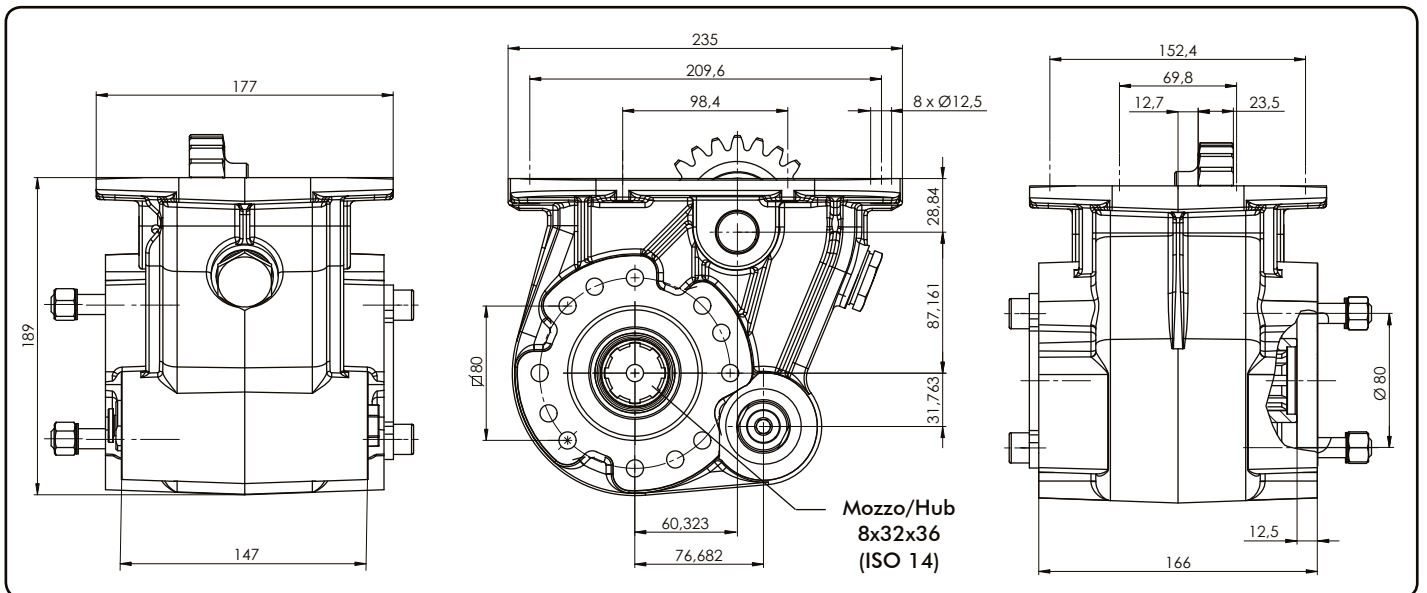
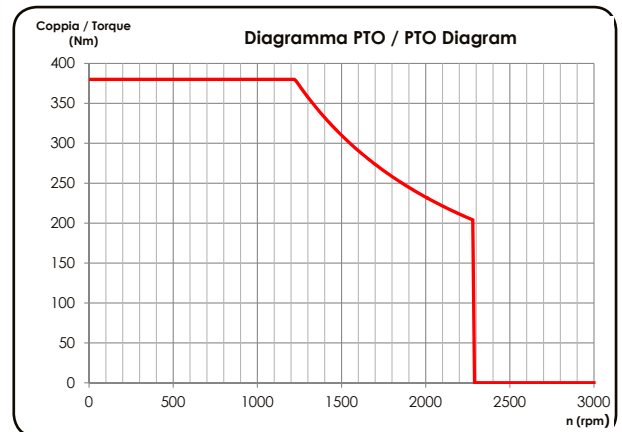

Tipo cambio Gearbox	Codice PTO PTO code	Versione Version	Giri pto a 1000 giri motore Pto ratio@1000 eng.rpm	Coppia massima Max. torque	Lato montaggio Mounting side	Uscita Output	Rotazione Rotation	Kit di montaggio Mounting kit	Peso Weight
Vedi indice See index	050-046-00171	17	Vedi indice See index	380 Nm	Infer. Low side	Posteriore Rear	Oraria Clockwise	154-003-06014	19Kg

pag.1



O.M.F.B. S.p.A. Hydraulic Components
We reserve the right to make any changes without notice.
Edition 2016.11 No reproduction, however partial, is permitted.
Via Cave, 7/9 25050 Provaglio d'Iseo (Brescia) Italy Tel.: +39.030.9830611
Fax: +39.030.9839207-208 Internet:www.omfb.it e-mail:info@omfb.it

COMPANY WITH
QUALITY SYSTEM
CERTIFIED BY DNV GL
= ISO 9001 =