

SECTION B-B

40 Nm

45 Nm

Dimensions w/o tol. are reference

For operating condition outside those stated, please consult Casappa S.p.A. Technical sales department

PAGE 1 OF 4

Signature for approval  
 \_\_\_\_\_  
 Date: \_\_\_\_\_

Cap.Forn./Rules Suppl.	Trattamento Termico / Heat Treatment	Trattamento Superficiale / Surface Treatment	Prof.(mm) / Depth
-	-	-	-
Quote senza indicazione di tolleranza / Unless otherwise specified tolerances		Materiale / Material	Durezza / Hardness
GRADO DI PRECISIONE ACCURACY LEVEL		-	-
Disegnato/Drawn	Approvato/Approved	Mod.Tecn./ Release change	Progetto/Project
Date	18-09-2017	18-09-2017	B895
Firma	RossiC	GuidettiM	11671
Signature			File
			01999804
Descrizione / Description			Scala/Scale
MOTORE PLM20.11,2R0-82E2-LEA/EA-N-EL			7:10
MOTOR PLM20.11,2R0-82E2-LEA/EA-N-EL			Formato/Size
			A3
Codice / Code			Ind. Mod./ Index Rev.
01999804			1
Sostituisce / It replaces			

**CASAPPA**  
 FLUID POWER DESIGN

The information hereon is the property of CASAPPA Spa. Without written permission, any copying, trasmittal to others and any use except that for which it's loaned, is prohibited.

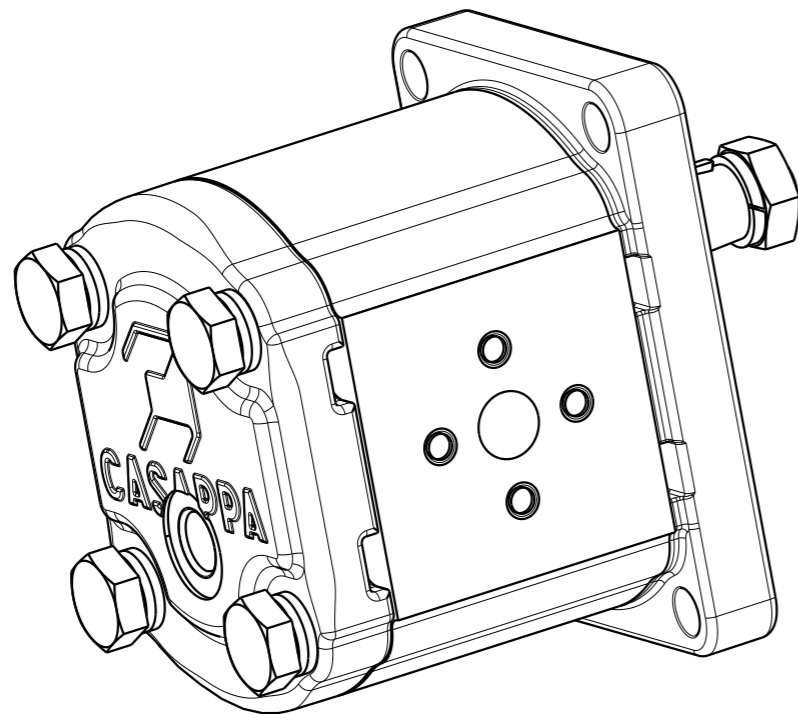
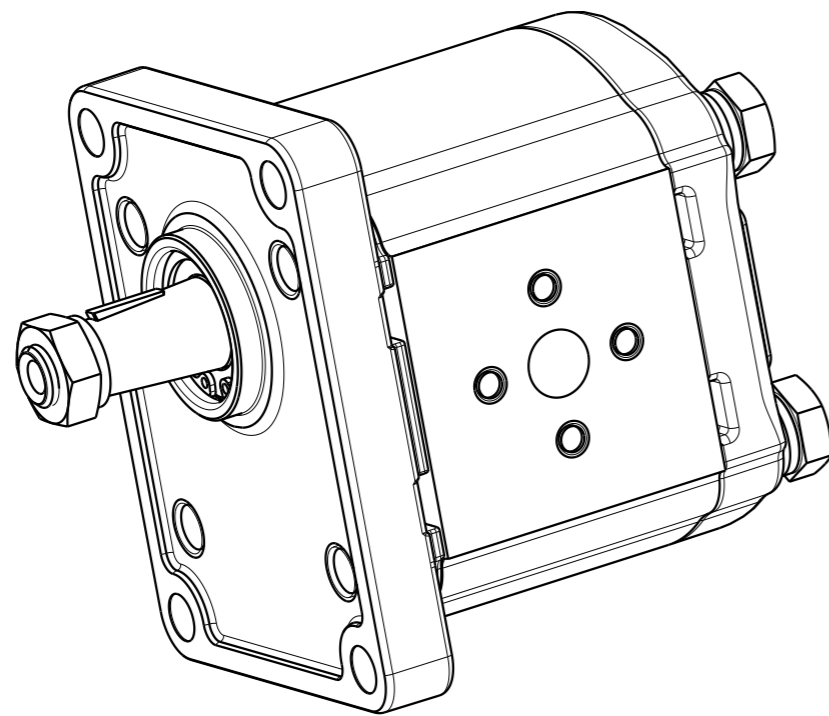

### MOTOR DATA

Senso di rotazione (guardando l'albero conduttore) Direction of rotation (looking on drive shaft)		Reversibile (R) Reversible (R)
Cilindrata - Displacement		11.23 [cm3/rev]
Pressione max continua - Max continuous pressure	P1	250 [bar]
Pressione max intermittente - Max intermittent pressure	P2	280 [bar]
Pressione max picco - Max peak pressure	P3	300 [bar]
Pressione max sullo scarico dei motori unidirezionali Max back pressure for single rotation motors	P1 (cont.)	- [bar]
	P2 (20 s)	- [bar]
	P3 (8 s)	- [bar]
Pressione max sul drenaggio dei motori reversibili Max drain line pressure on the reversible rotation motors		5 [bar]
Velocità - Speed	min P1	600 [min <sup>-1</sup> ]
	max P1	3500 [min <sup>-1</sup> ]
Guarnizioni - Seals type		NBR
Temperatura minima - Min temperature		- 25 [°C]
Temperatura massima - Max temperature	continuous	+ 80 [°C]
	peak	+ 100 [°C]
Campo di viscosità - Viscosity range	recommended	12 to 100 mm <sup>2</sup> /s (cSt)
	permitted	max 750 mm <sup>2</sup> /s (cSt)
Classe di contaminazione - Contamination class	Δp > 200 bar βx = 75 - 10 μm	8 - Nas 1638
		19/17/14 - ISO 4406
	Δp < 200 bar βx = 75 - 25 μm	10 - Nas 1638
		21/19/16 - ISO 4406
Codice del prototipo - Prototype code		-
Codice cliente - Customer code		-
Valvola di massima pressione - Relief valve		- [bar]
Pressione di stand-by valvola LS - Stand-by pressure LS valve		- [bar]
Peso - Weight		2.600 [kg]
Vernice - Painting		-
Trattamenti speciali - Special treatment		

Cap.Forn./Rules Suppl.	Trattamento Termico / Heat Treatment	Trattamento Superficiale / Surface Treatment	Prof.(mm) / Depth
-	-	-	-
Quote senza indicazione di tolleranza / Unless otherwise specified tolerances		Materiale / Material	Durezza / Hardness
GRADO DI PRECISIONE / ACCURACY LEVEL		-	-
Disegnato/Drawn	Approvato/Approved	Mod.Tecn./ Release change	Progetto/Project
Date	18-09-2017	18-09-2017	B895
Firma / Signature	RossiC	GuidettiM	11671
			File
			01999804
			Stato / Process
			-
			Codice Grezzo / Master Code
			-
			Scala/Scale
			7:10
			Formato/Size
			A3
			Ind. Mod./ Index Rev.
			1
			Descrizione / Description
			MOTORE PLM20.11,2R0-82E2-LEA/EA-N-EL
			MOTOR PLM20.11,2R0-82E2-LEA/EA-N-EL
			Codice / Code
			01999804
			Sostituisce / It replaces
			-

For operating condition outside those stated, please consult Casappa S.p.A. Technical sales department



The information hereon is the property of CASAPPA Spa. Without written permission, any copying, transmittal to others and any use except that for which it's loaned, is prohibited.

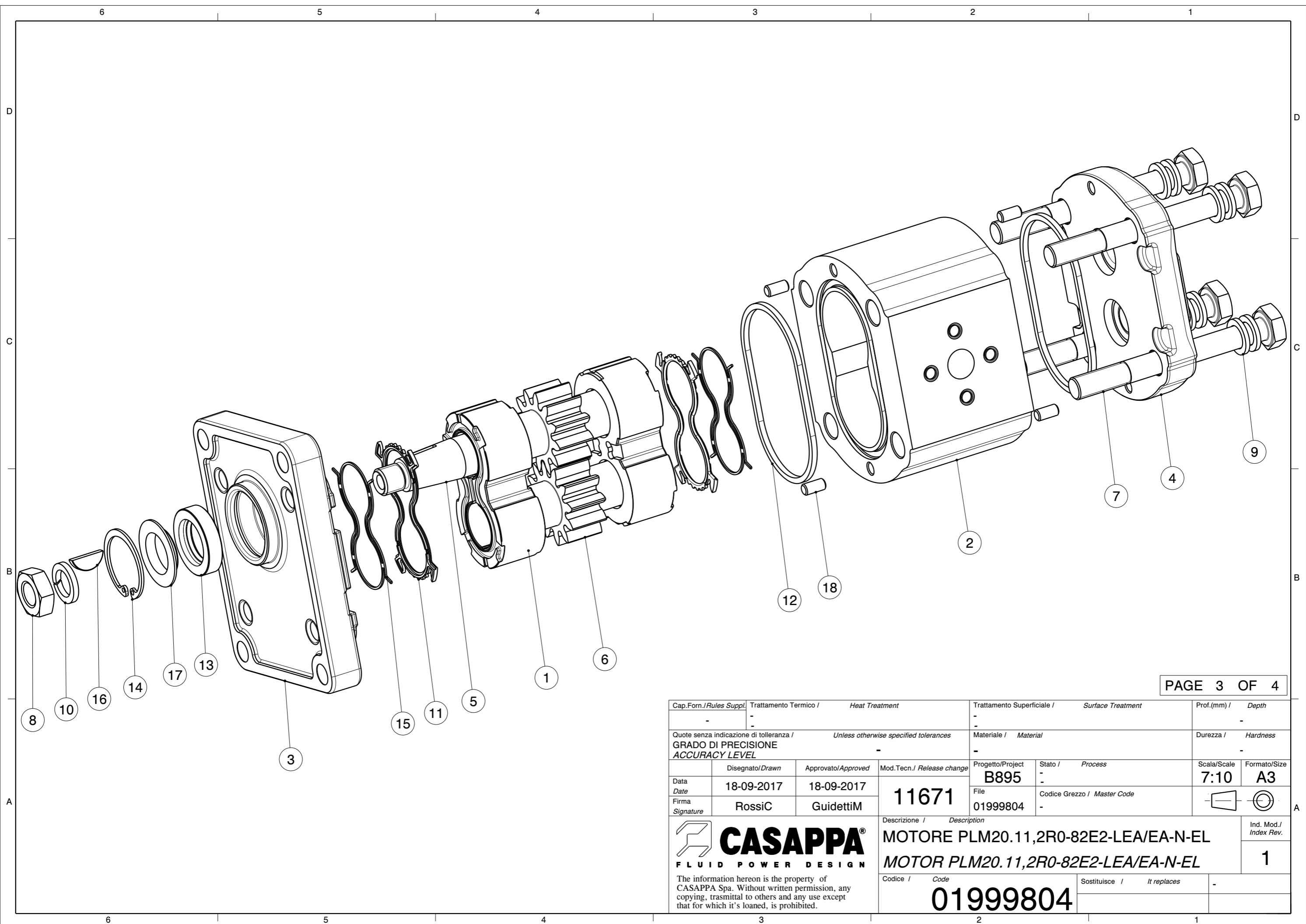

Cap.Forn./Rules Suppl. -	Trattamento Termico / Heat Treatment -	Trattamento Superficiale / Surface Treatment -	Prof.(mm) / Depth -
Quote senza indicazione di tolleranza / Unless otherwise specified tolerances <b>GRADO DI PRECISIONE ACCURACY LEVEL</b>		Materiale / Material -	Durezza / Hardness -
Disegnato/Drawn	Approvato/Approved	Mod.Tecn./ Release change	Progetto/Project
Date	18-09-2017	18-09-2017	B895
Firma	RossiC	GuidettiM	11671
		File	01999804
		Descrizione / Description	MOTORE PLM20.11,2R0-82E2-LEA/EA-N-EL MOTOR PLM20.11,2R0-82E2-LEA/EA-N-EL
		Codice / Code	01999804
		Sostituisce / It replaces	-
			Ind. Mod./ Index Rev. 1



The information hereon is the property of CASAPPA Spa. Without written permission, any copying, transmittal to others and any use except that for which it's loaned, is prohibited.

Pos.	Codice Code	Kit	Q.tà Q.ty	Descrizione Description	Indice modifica Index revision
18	49270000		4	SPINA MM.5x10 UNI1707 H8 DOWEL PIN MM.5x10 UNI1707 H8	1
17	45620000		1	PIASTRINA PARAOLIO GR.2 BACK-UP WASHER GR.2	3
16	42520000		1	LINGUETTA 3.15X6.5 280 HB KEY 3.15X6.5	1
15	41387112		2	ANTIESTRUSORE Z PL20 R T.N. ANTIEXTRUSION Z PL20 R T.N.	2
14	40661000		1	ANELLO 30 UNI 7437-DIN 472 RING 30 UNI 7437-DIN 472	0
13	39800000		1	PARAOLIO BAU2 18X30X7 SHAFT SEAL BAU2 18X30X7	0
12	39666195		2	GUARNIZIONE PL 20 STANDARD SEZIONE QUADRATA STANDARD SEAL PL 20 SQUARE SECTION	0
11	39656112		2	GUARNIZIONE PL20 R T.N. SEAL PL20 R N T.N.	2
10	37583803		1	ROSETTA 12 DIN 7980 GEOMET 321/A WASHER 12 DIN 7980 GEOMET321/A	0
9	37583716		8	ROSETTA 10 (10,5x16x2) HV300 GEOMET 321/A WASHER 10 (10,5x16x2) HV300 GEOMET 321/A	0
8	36860000		1	DADO M 12X1,5 UNI 5589-A-6S-GEOMET 321/A PLUS M NUT M 12X1,5 UNI 5589-A-6S-GEOMET 321/A PLUS M	0
7	36593010		4	VITE TE M 10X95 5737 10.9 GEOMET 321/A PLUS M SCREW TE M 10X95 5737 10.9 GEOMET 321/A PLUS M	0
6	27750030		1	INGR.CONDOTTO F-K-PL20.11,2 DRIVEN GEAR F-K-PL20.11,2	4
5	27720030		1	INGR.CONDUTTORE K-PL20.11,2-82 DRIVE SHAFT K-PL20.11.2-82	3
4	21918652		1	COPERCHIO POST. PL20-R/AL TN REAR COVER PL20-R/AL TN	3
3	21911152		1	COPERCHIO ANT.PL20/AL FRONT COVER PL20/AL	9
2	17672140		1	CORPO PL20.11,2-LEA/EA BODY PL20.11.2-LEA/EA	9
1	25930700		2	RASAMENTO PL20 R (ES) THRUST PLATE PL20 R (ES)	2

Cap.Forn./Rules Suppl.		Trattamento Termico / Heat Treatment		Trattamento Superficiale / Surface Treatment		Prof.(mm) / Depth	
-		-		-		-	
Quote senza indicazione di tolleranza / Unless otherwise specified tolerances				Materiale / Material		Durezza / Hardness	
GRADO DI PRECISIONE ACCURACY LEVEL				-		-	
	Disegnato/Drawn	Approvato/Approved	Mod.Tecn./Release change	Progetto/Project	Stato / Process	Scala/Scale	Formato/Size
Data Date	18-09-2017	18-09-2017	11671	B895	-	7:10	A4
Firma Signature	RossiC	GuidettiM		File	Codice Grezzo / Master Code		
				01999804			
<b>CASAPPA®</b> <b>FLUID POWER DESIGN</b>						Descrizione / Description <b>MOTORE PLM20.11,2R0-82E2-LEA/EA-N-EL</b> <b>MOTOR PLM20.11,2R0-82E2-LEA/EA-N-EL</b>	
The information hereon is the property of CASAPPA Spa. Without written permission, any copying, trasmittal to others and any use except that for which it's loaned, is prohibited.						Ind. Mod./ Index Rev. <b>1</b>	
				Codice / Code		Sostituisce / It replaces	
				01999804		-	